

# **BJERRING**

## **SIBIO**





# MODERN AND PRACTICAL

*Sibio is a cubic-shaped chair that is designed for closed sports and entertainment venues. Due to its small dimensions after folding, the chair can be successfully used for telescopic tribunes. Another advantage is the possibility to change the angle of the chair arrangement relative to the tribune.*



Thanks to its steel structure, the Sibio chair is highly durable. From an aesthetic point of view, another great feature is the possibility to paint the chair structure in a colour chosen by the client. The seat and backrest (which is available in three different heights) are made of beech plywood and can be fitted with upholstered overlays that increase comfort of use. Depending on the clients preferences, it is possible to fix armrests with pads made of solid wood or polyurethane to the beam the chair is mounted to. All these features give the venue a wide range of arrangement possibilities.

Another unquestionable advantage is the possibility to rotate the Sibio chair and change its position in the auditorium, after unlocking the appropriate safety elements. Once the chair has been repositioned as required, the mechanism has to be locked again.

The Sibio version designed for telescopic tribunes is equipped with a manual system for folding sets of chairs or, optionally, with gas springs that ensure the folding process is smoother and more comfortable.





Sibio  
DIMENSIONS\*:

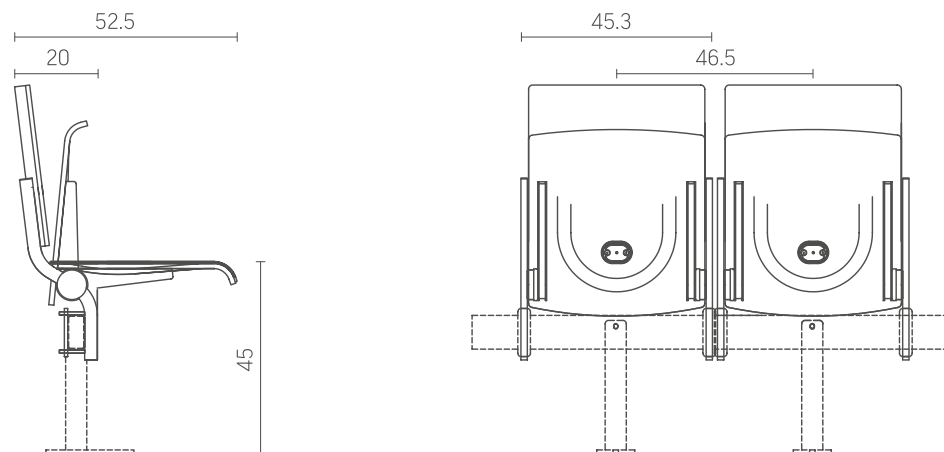

Sibio with one armrest  
DIMENSIONS\*:

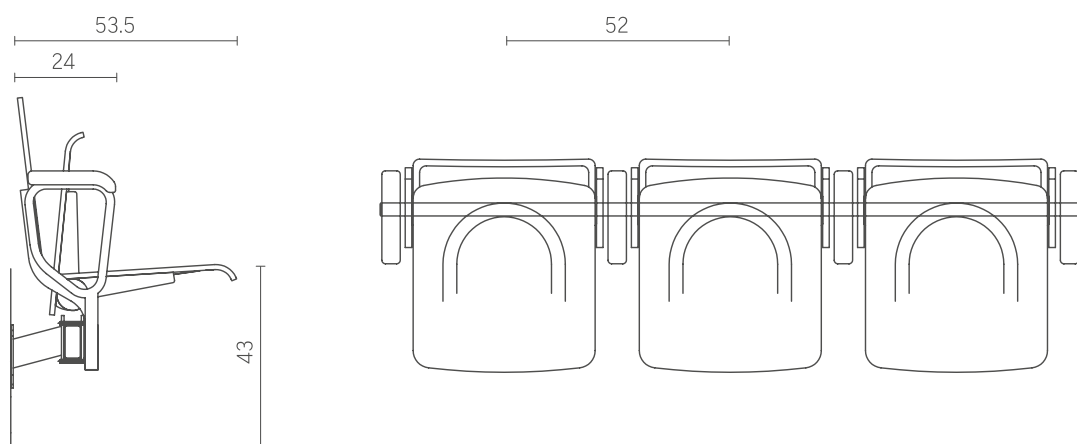

Sibio with two armrests  
DIMENSIONS\*:

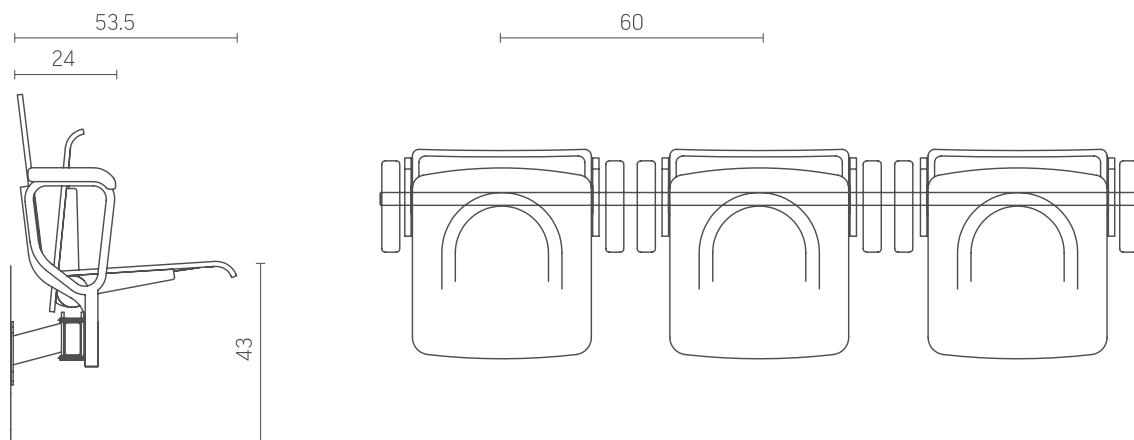

Sibio for telescopic tribunes  
DIMENSIONS\*:

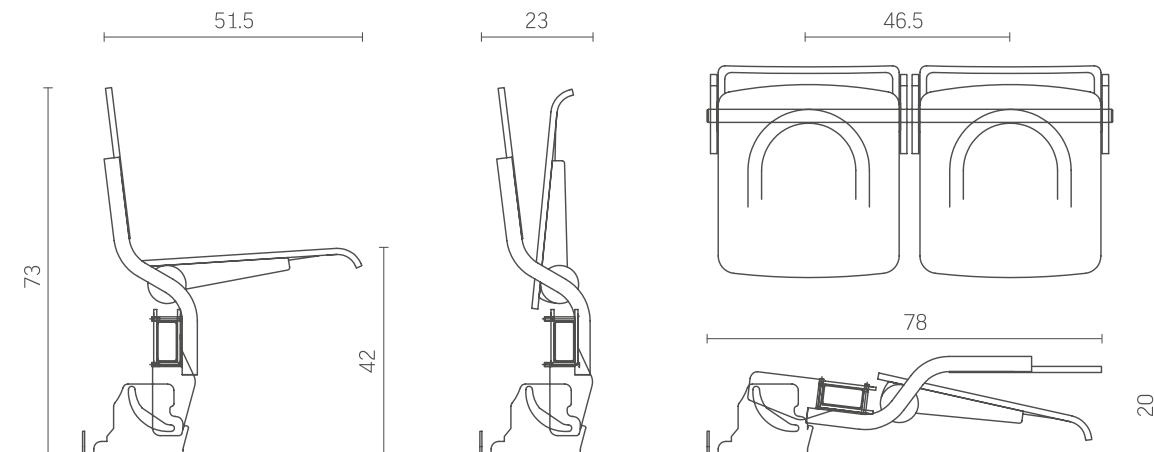

Swivel Sibio for telescopic tribunes  
DIMENSIONS\*:

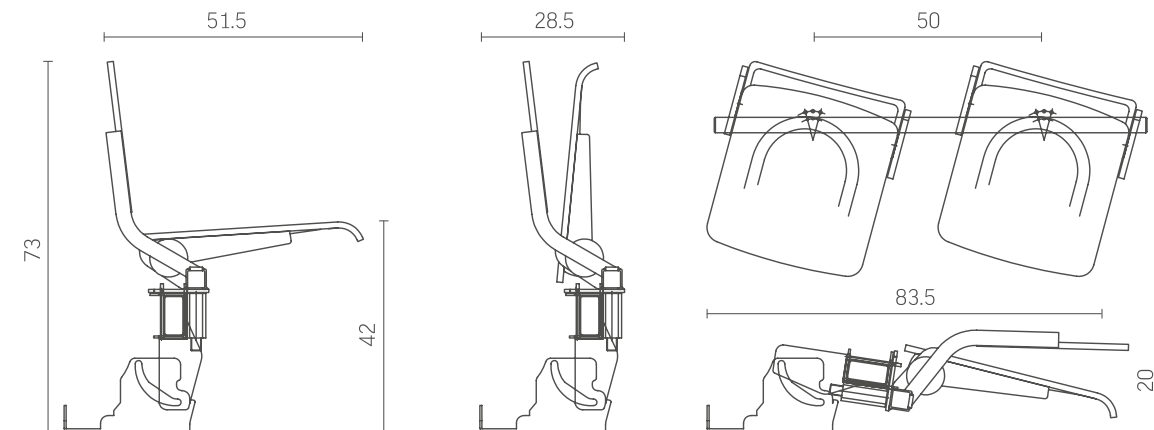

Swivel Sibio  
DIMENSIONS\*:

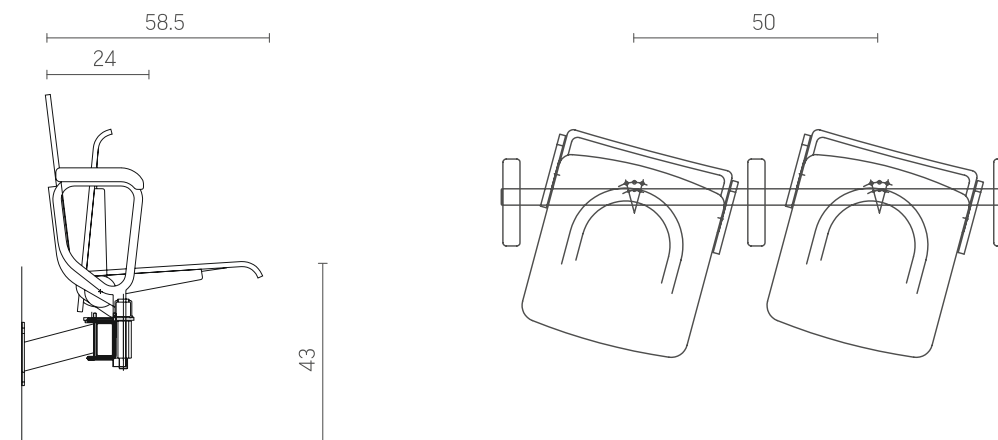

\* All dimensions are in centimetres.

\* All dimensions are in centimetres.



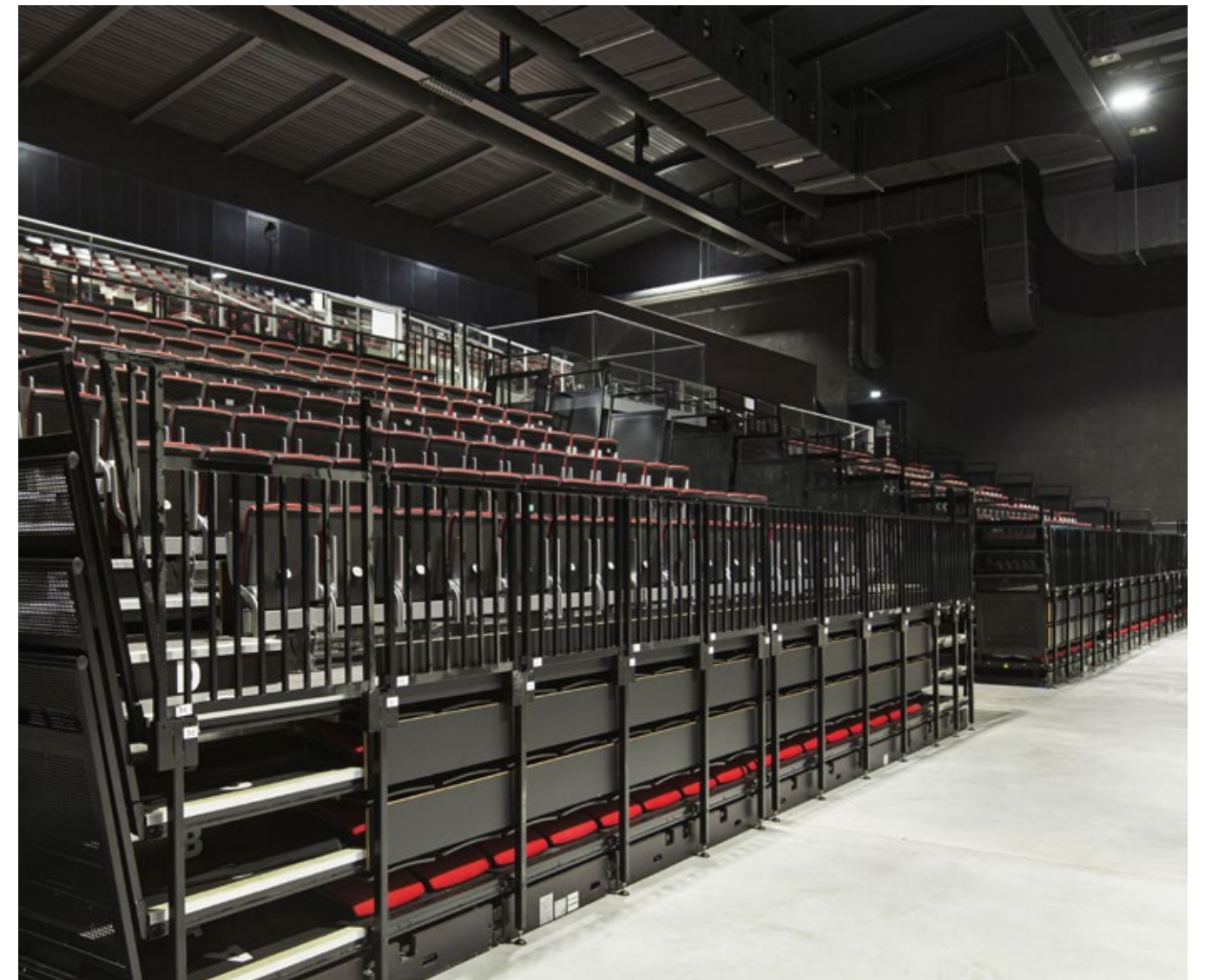

#### CHARACTERISTIC FEATURES AND AVAILABLE OPTIONS:

- Narrow chair that ensures a wide distance between rows.
- Comfortable contouring.
- Three backrest heights.
- Armrests made of polyurethane or solid beech wood.
- Quiet spring folding mechanism.
- Small dimensions at the tribune after folding 20 cm.
- Change of the chair angle relative to the tribune (-15 degrees, 0 degrees, +15 degrees).

#### CERTIFIED PRODUCTION:

We manufacture products at a global level. Our chairs are characterised by top quality and the highest durability. In all of our production plants we have implemented the best quality management system **ISO 9001:2000**. At the same time, we take care of the natural environment. We use the environmental management systems created according to the **ISO 14001** standard in the majority of our factories. This enables us to minimise our impact on the natural environment and confirms that our products contain no heavy metals.

#### ASSEMBLY OPTIONS:

Floor type:



Flat



Inclined



Stairs

Armchair arrangement:



In a straight line



In a curve

Assembly type:



TYPE B  
to the step  
riser

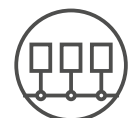

TYPE C  
to the floor  
riser



# **BJERRING**

